

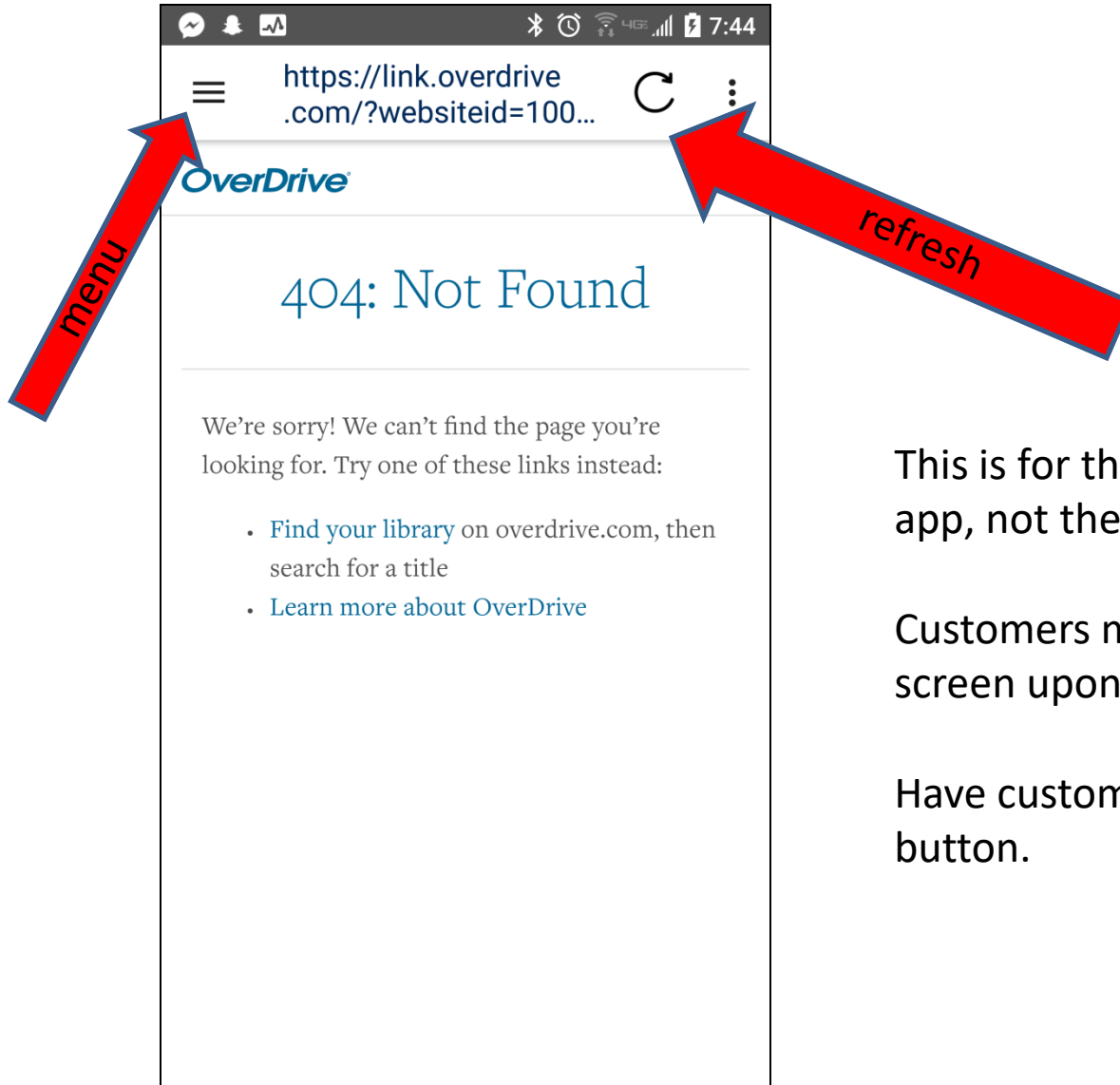

Silver Star eLibrary





This is for the original OverDrive app, not the new Libby app.

Customers may encounter an error screen upon opening the app.

Have customers click the menu button.

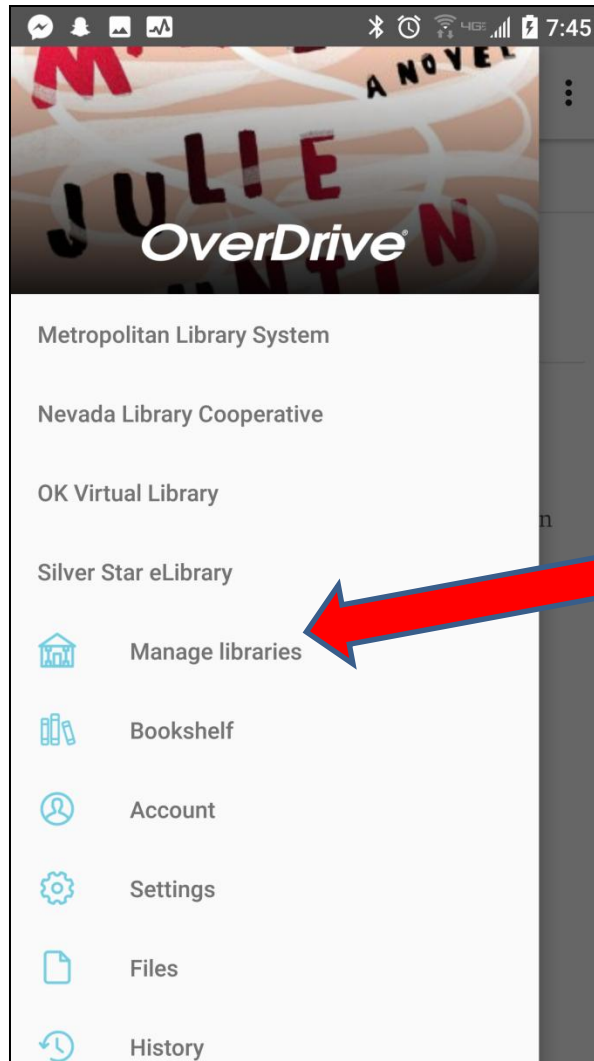

When the menu slides open from the left, choose Manage Libraries

If the menu will not let the customer click Manage Libraries, try using the phone's back button, or try hitting the refresh button in the app (see 1st page of this doc).

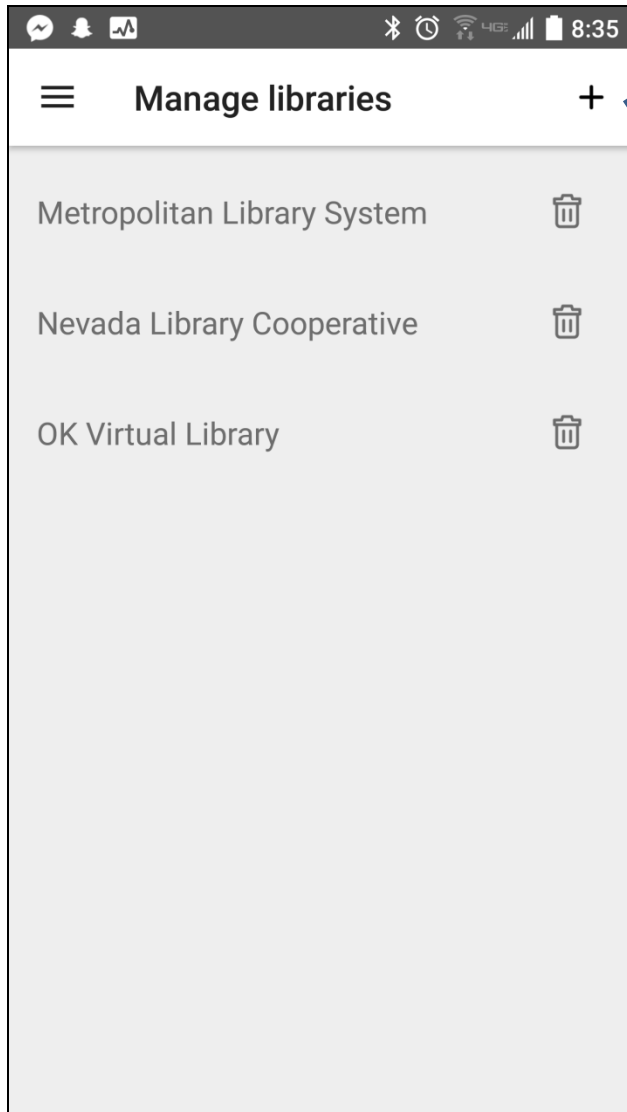

Click the plus sign to bring up the search function.

Search for SilverStar, your town or zip code.

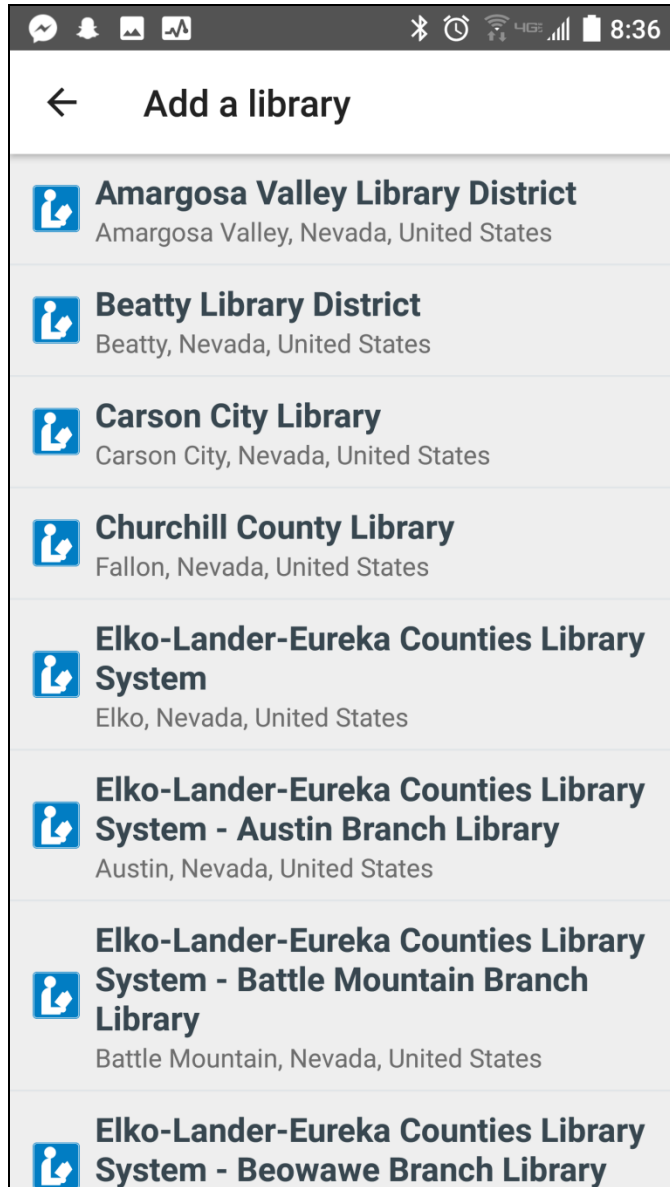

If you search SilverStar, you will get the complete list of participating libraries.

Select your library.

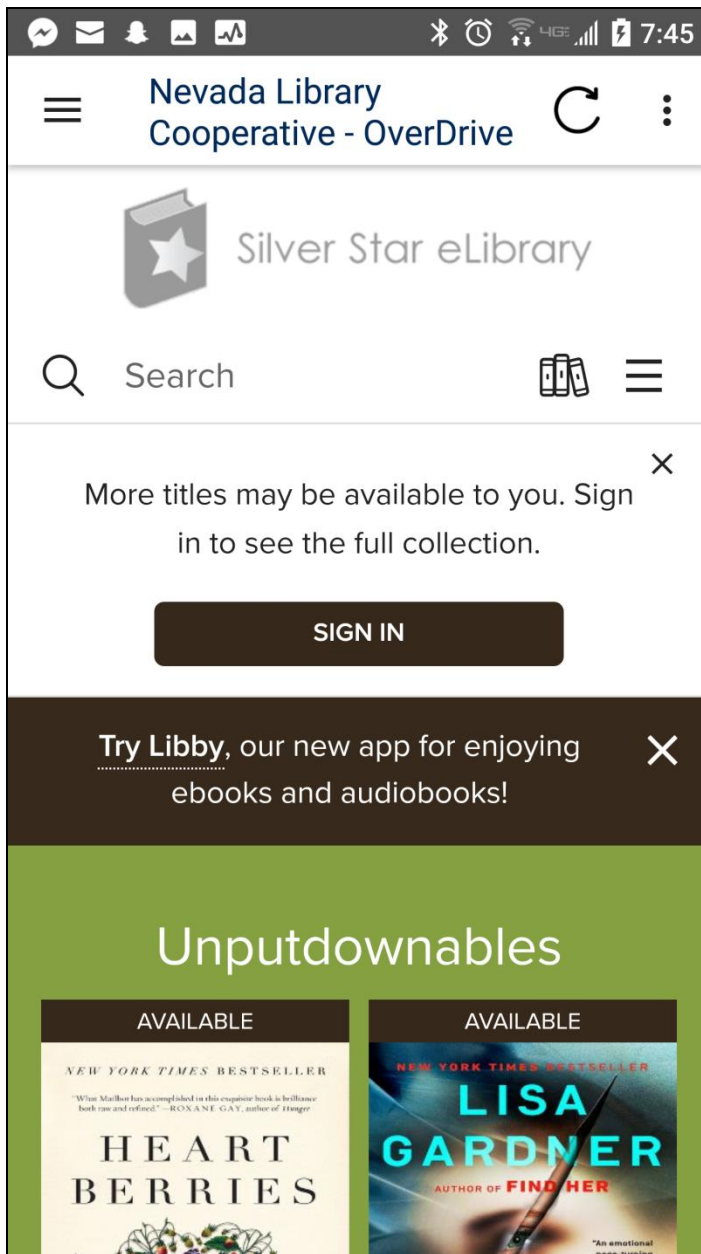

Once on the homescreen, customers can log in again.

They will be prompted to select their library from a drop down, then enter their library card number.

Customer's items should still be on their bookshelf. They may have to download it again but the app will prompt them to skip to where they left off.